

MOORE COUNTY AST

040397
 04-MAR-2024 10:34
 s:\n\ast\moore\2024\AST\Moore_Richmond_February2024_AST_Maps_Tip.dgn
 20240304 10:34 AM
 040397

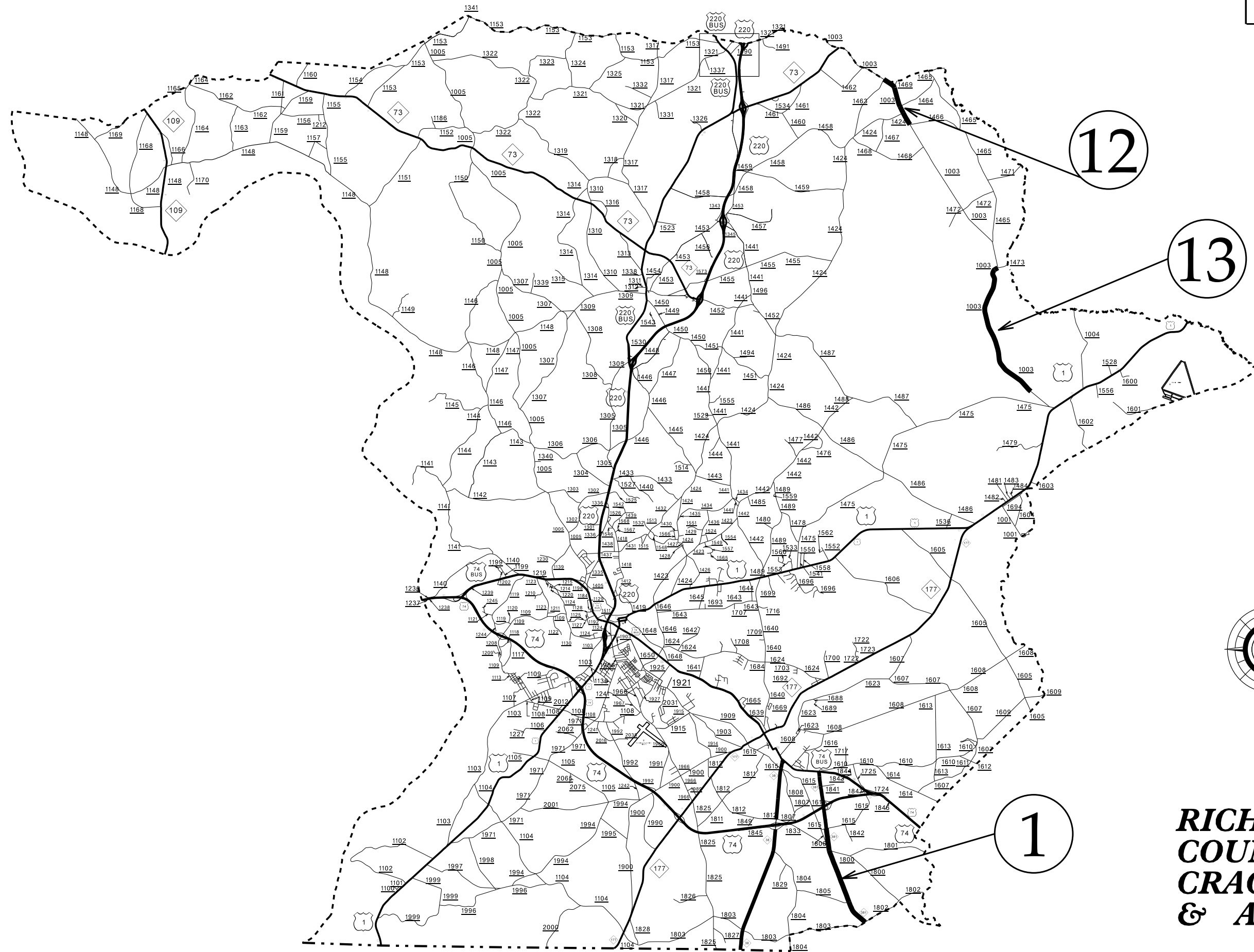

**RICHMOND
COUNTY
CRACK SEAL
& AST**

WBS ELEMENT	SHEET NO.
2024CPT.08.10.10772	3
2024CPT.08.10.20632	
2024CPT.08.10.20772	
8.206311 8.207711	

Map 1

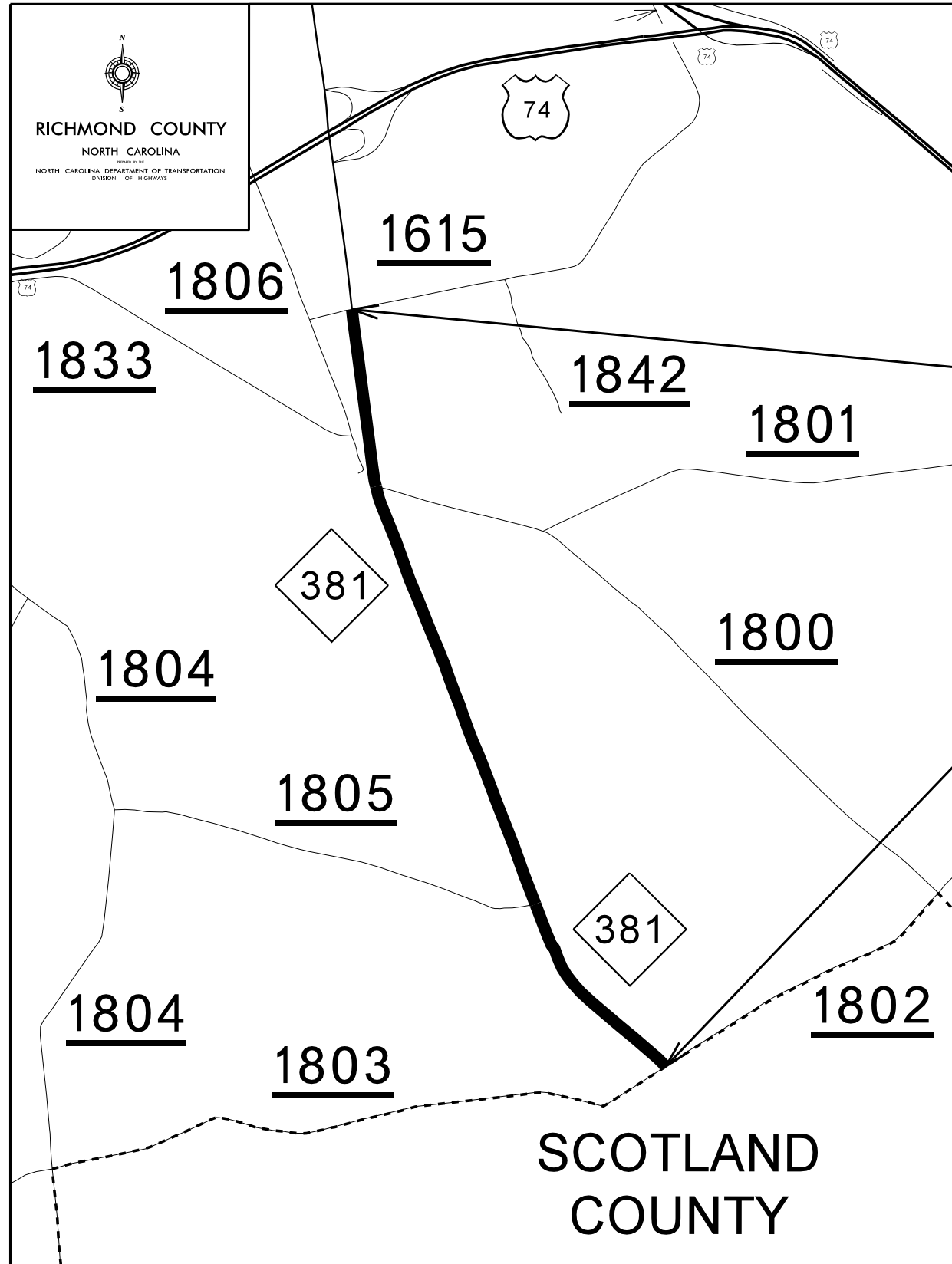

Map 2

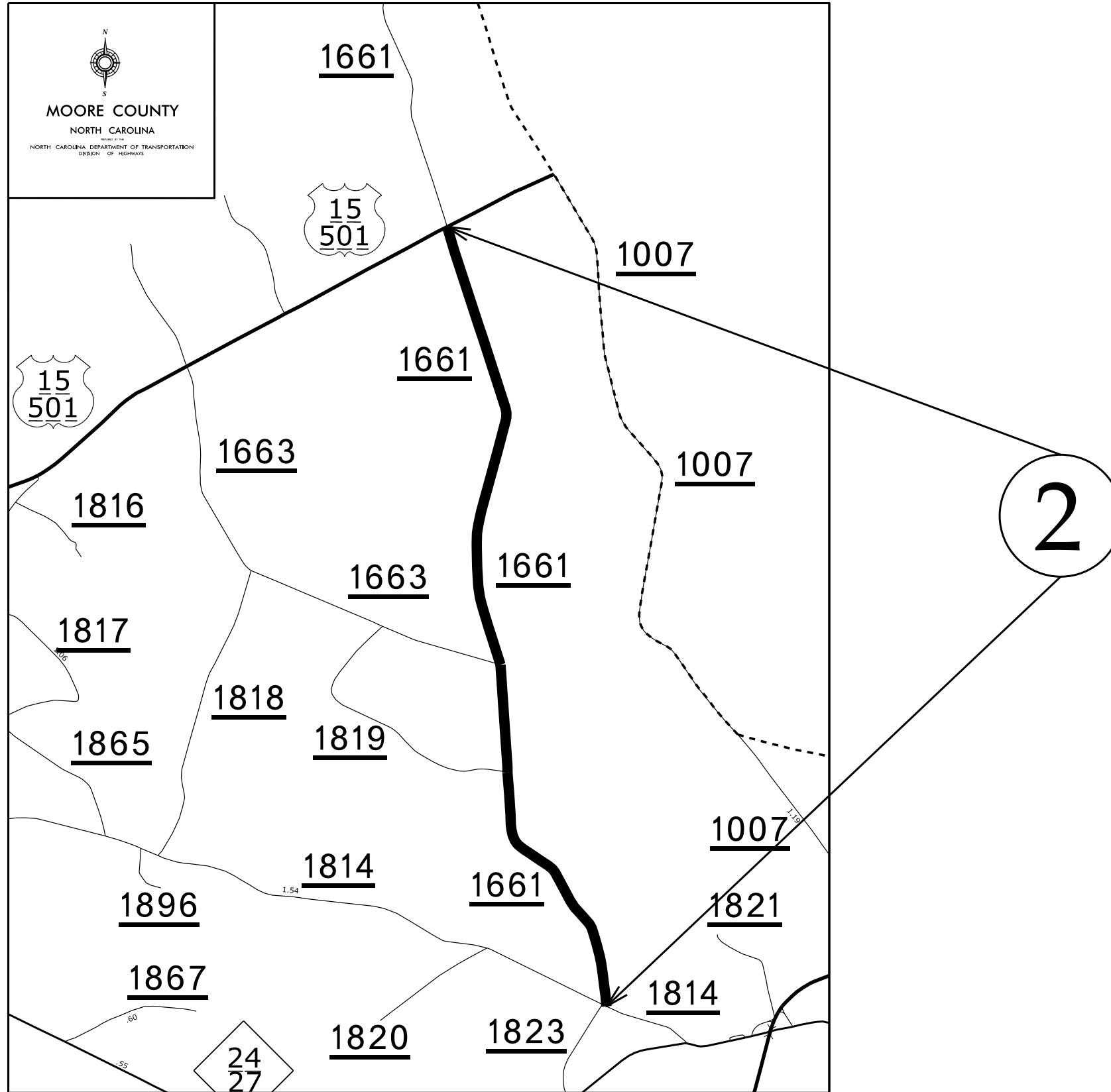

WBS ELEMENT	SHEET NO.
2024CPT.08.10.10772	5
2024CPT.08.10.20632	
2024CPT.08.10.20772	
8.206311	
8.207711	

Map 3

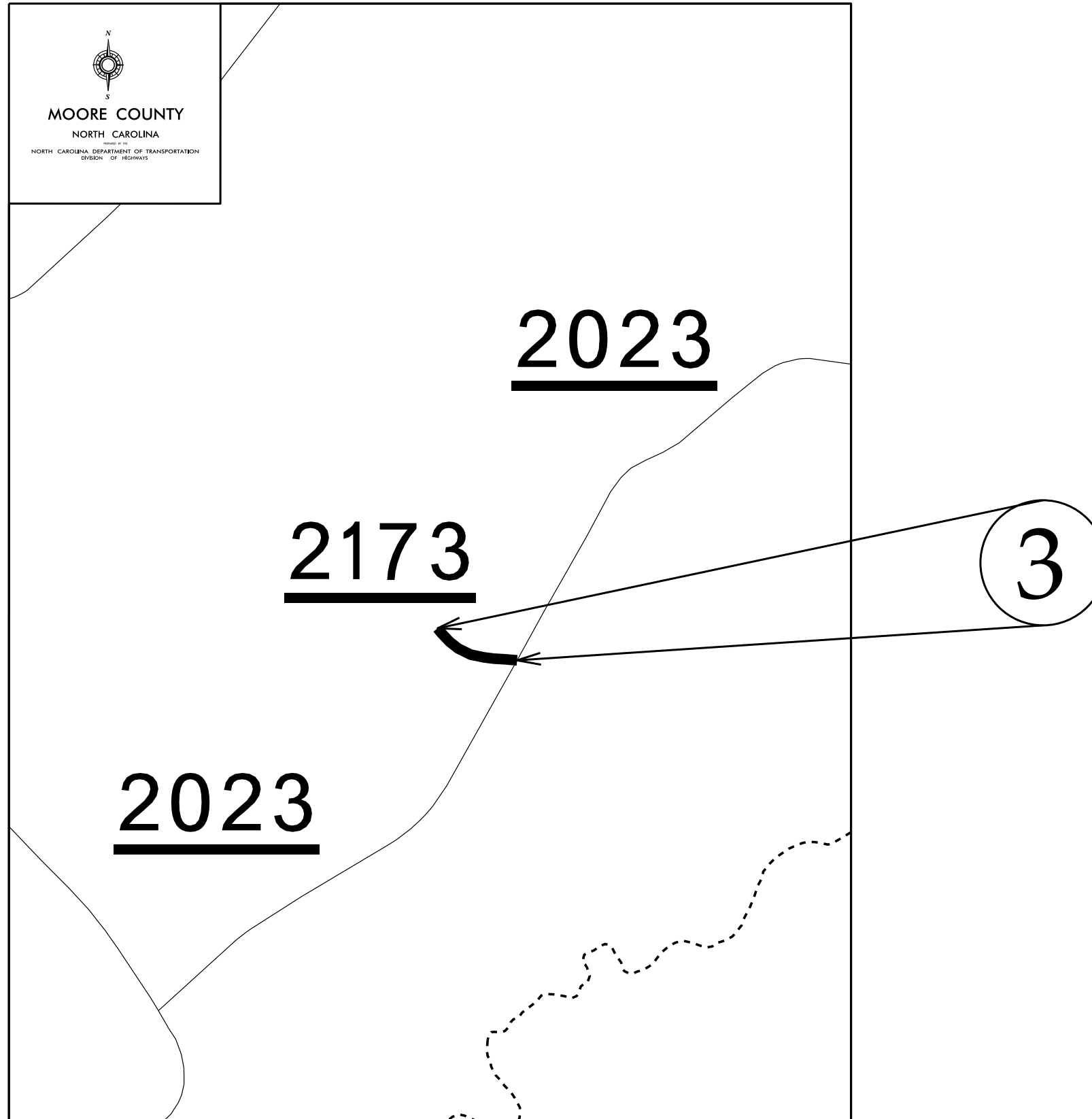

WBS ELEMENT	SHEET NO.
2024CPT.08.10.10772 2024CPT.08.10.20632 2024CPT.08.10.20772 8.206311 8.207711	6

Map 4

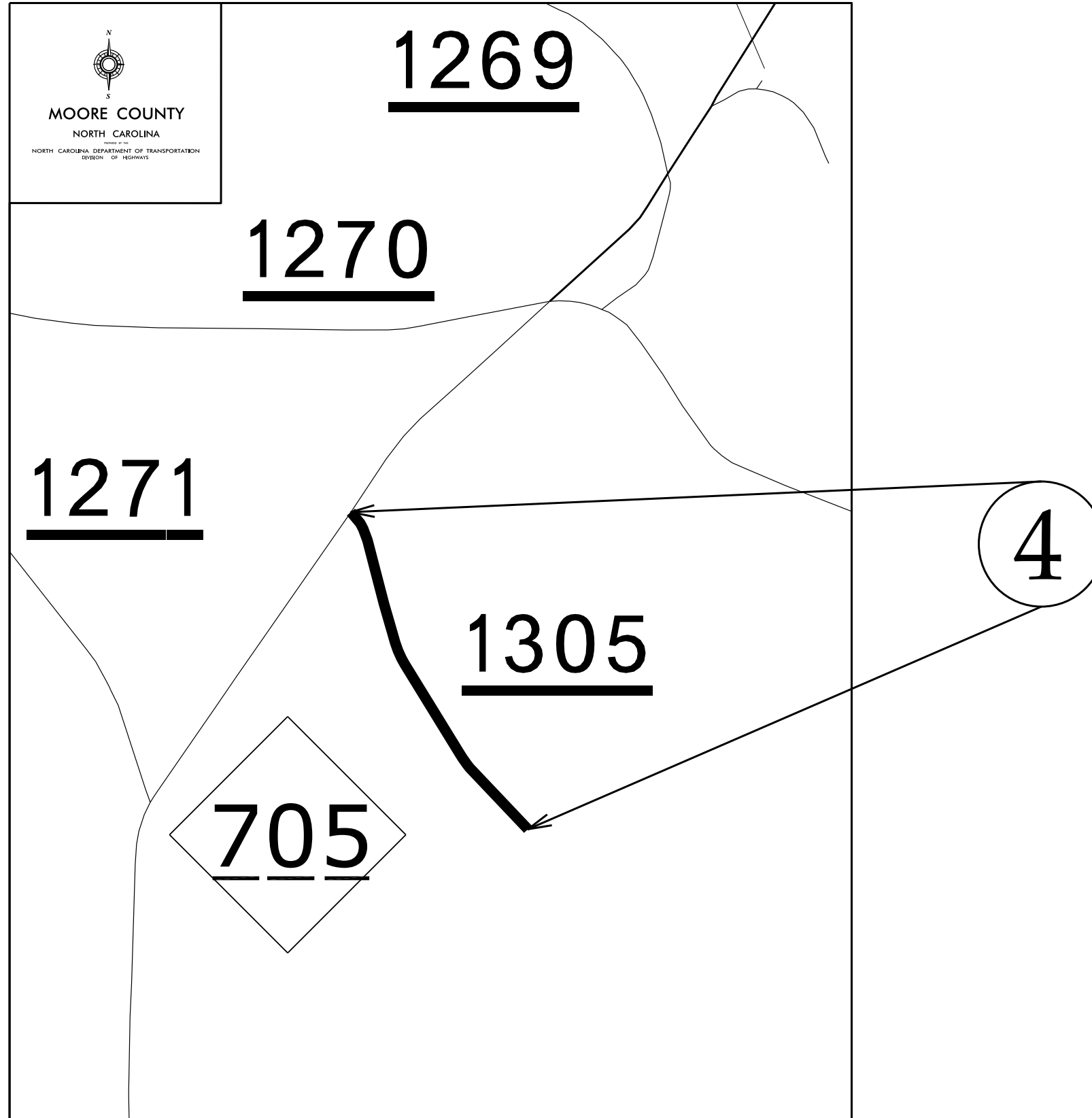

WBS ELEMENT	SHEET NO.
2024CPT.08.10.10772	8
2024CPT.08.10.20632	
2024CPT.08.10.20772	
8.206311 8.207711	

Map 6

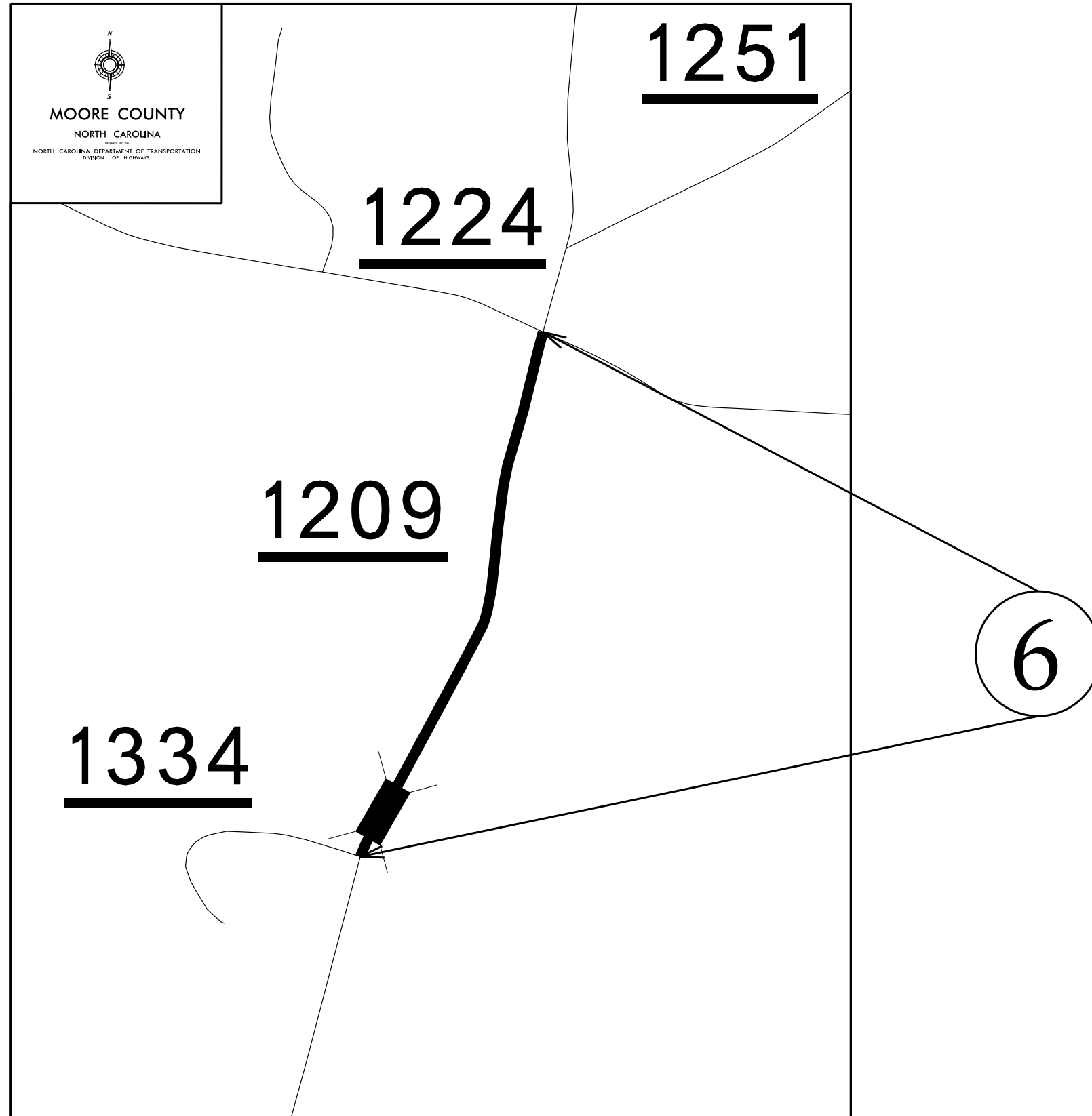

 MOORE COUNTY
 NORTH CAROLINA
NORTH CAROLINA DEPARTMENT OF TRANSPORTATION
 DIVISION OF HIGHWAYS

WBS ELEMENT	SHEET NO.
2024CPT.08.10.10772	9
2024CPT.08.10.20632	
2024CPT.08.10.20772	
8.206311 8.207711	

Map 7

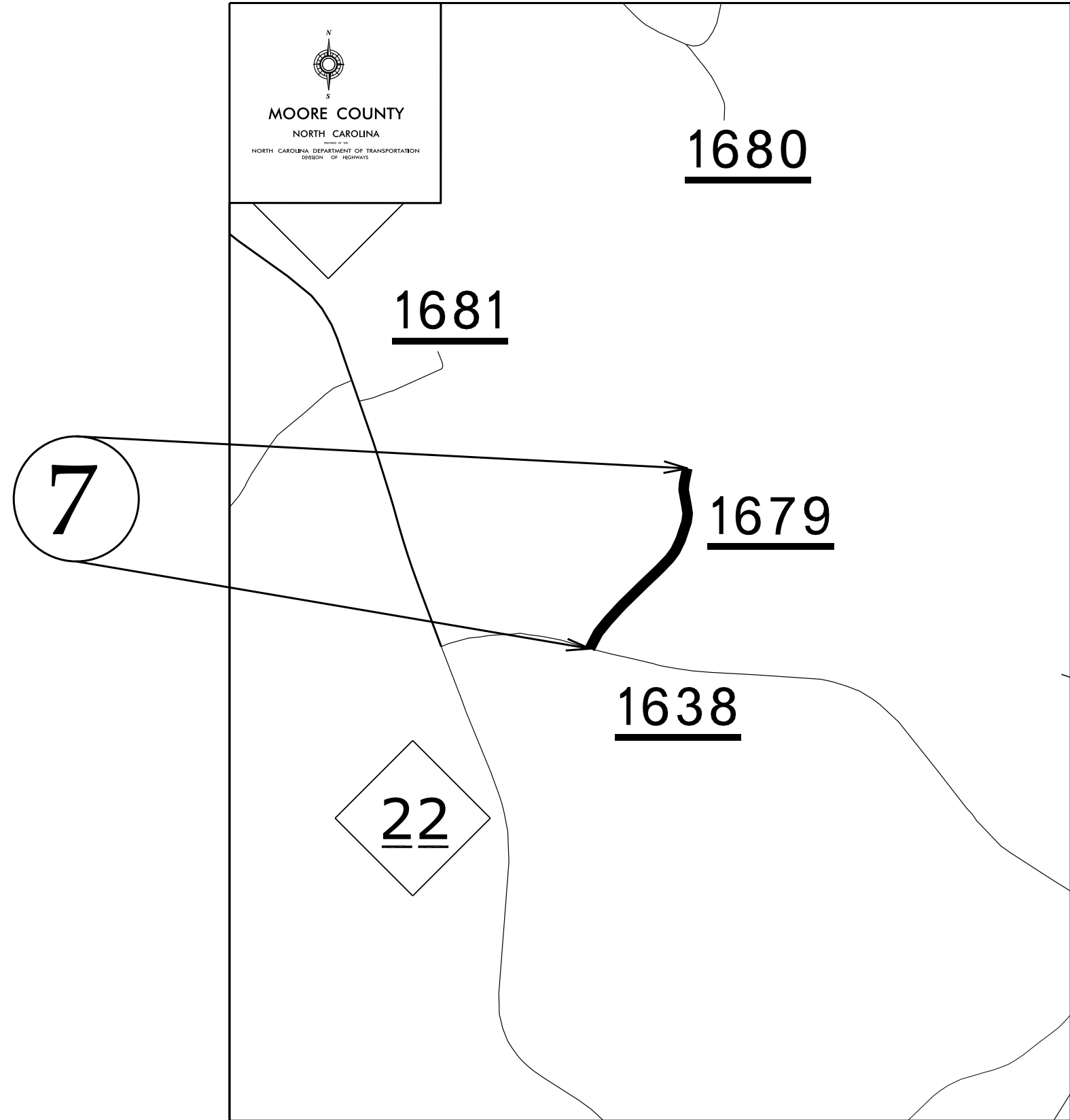

WBS ELEMENT	SHEET NO.
2024CPT.08.10.10772	10
2024CPT.08.10.20632	
2024CPT.08.10.20772	
8.206311 8.207711	

Map 8

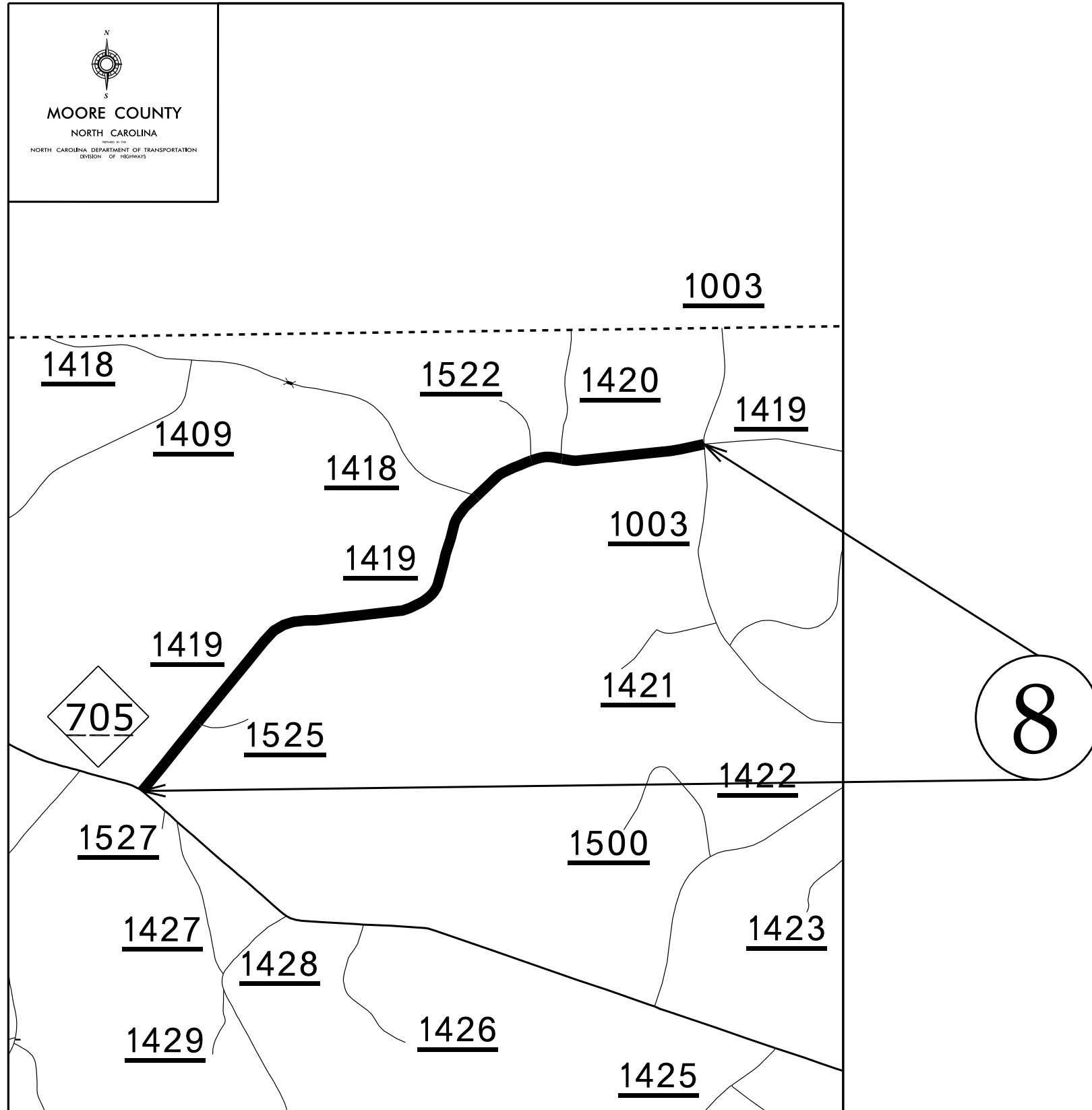

WBS ELEMENT	SHEET NO.
2024CPT.08.10.10772	11
2024CPT.08.10.20632	
2024CPT.08.10.20772	
8.206311 8.207711	

Map 9

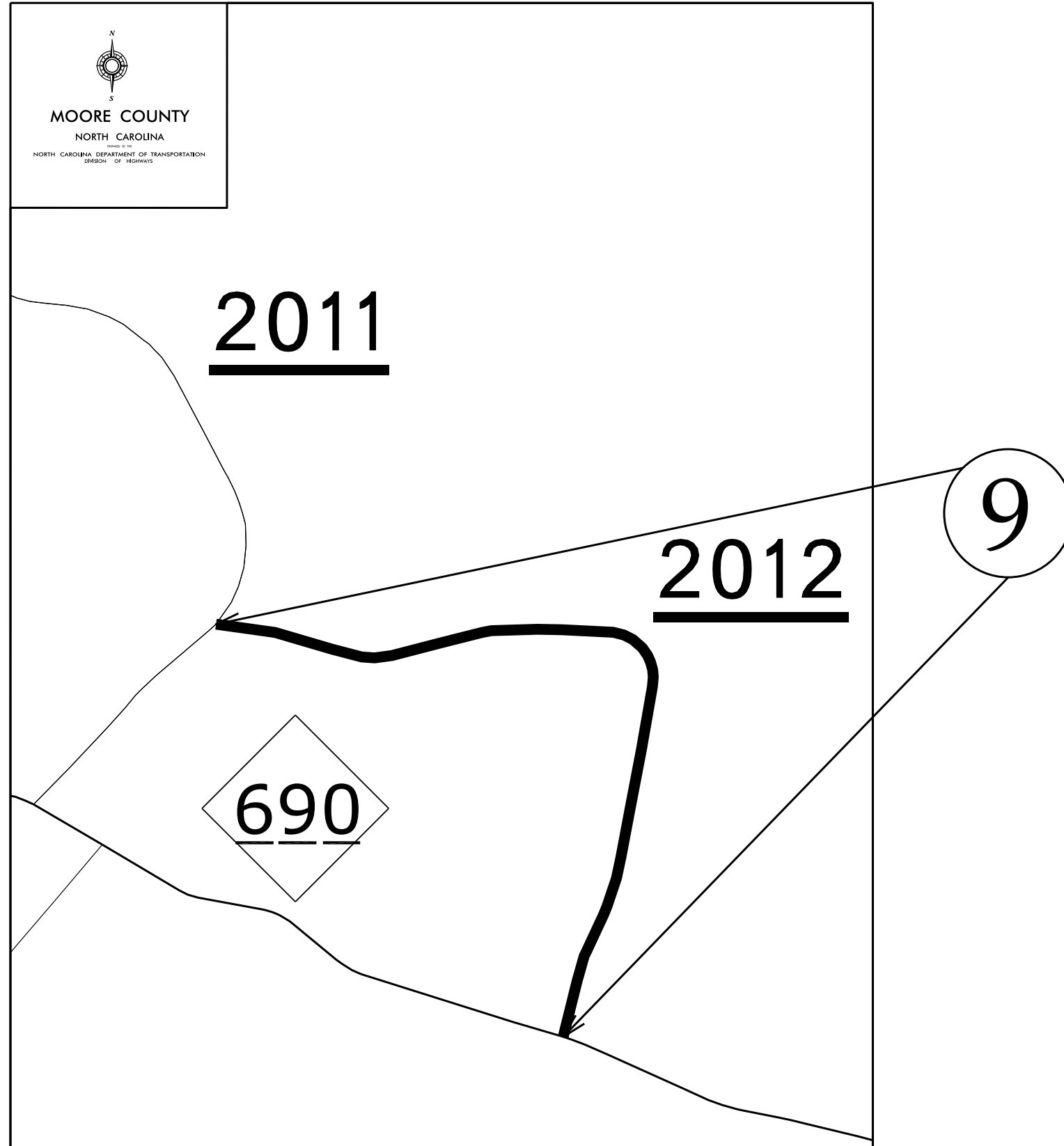

WBS ELEMENT	SHEET NO.
2024CPT.08.10.10772	12
2024CPT.08.10.20632	
2024CPT.08.10.20772	
8.206311 8.207711	

Map 10

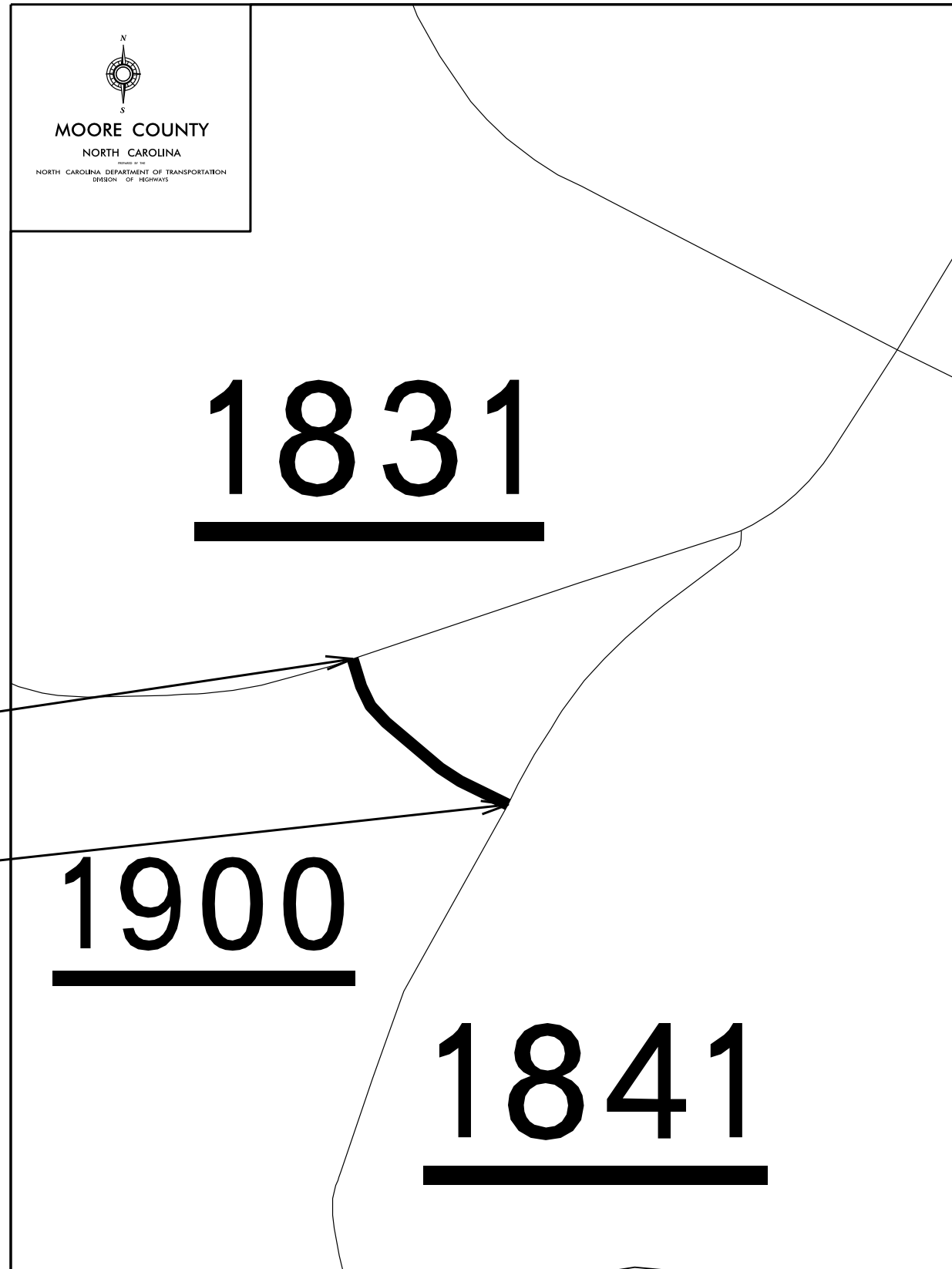

WBS ELEMENT	SHEET NO.
2024CPT.08.10.10772	13
2024CPT.08.10.20632	
2024CPT.08.10.20772	
8.206311 8.207711	

Map 11

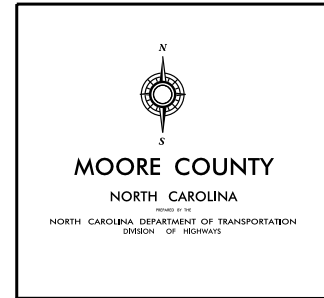
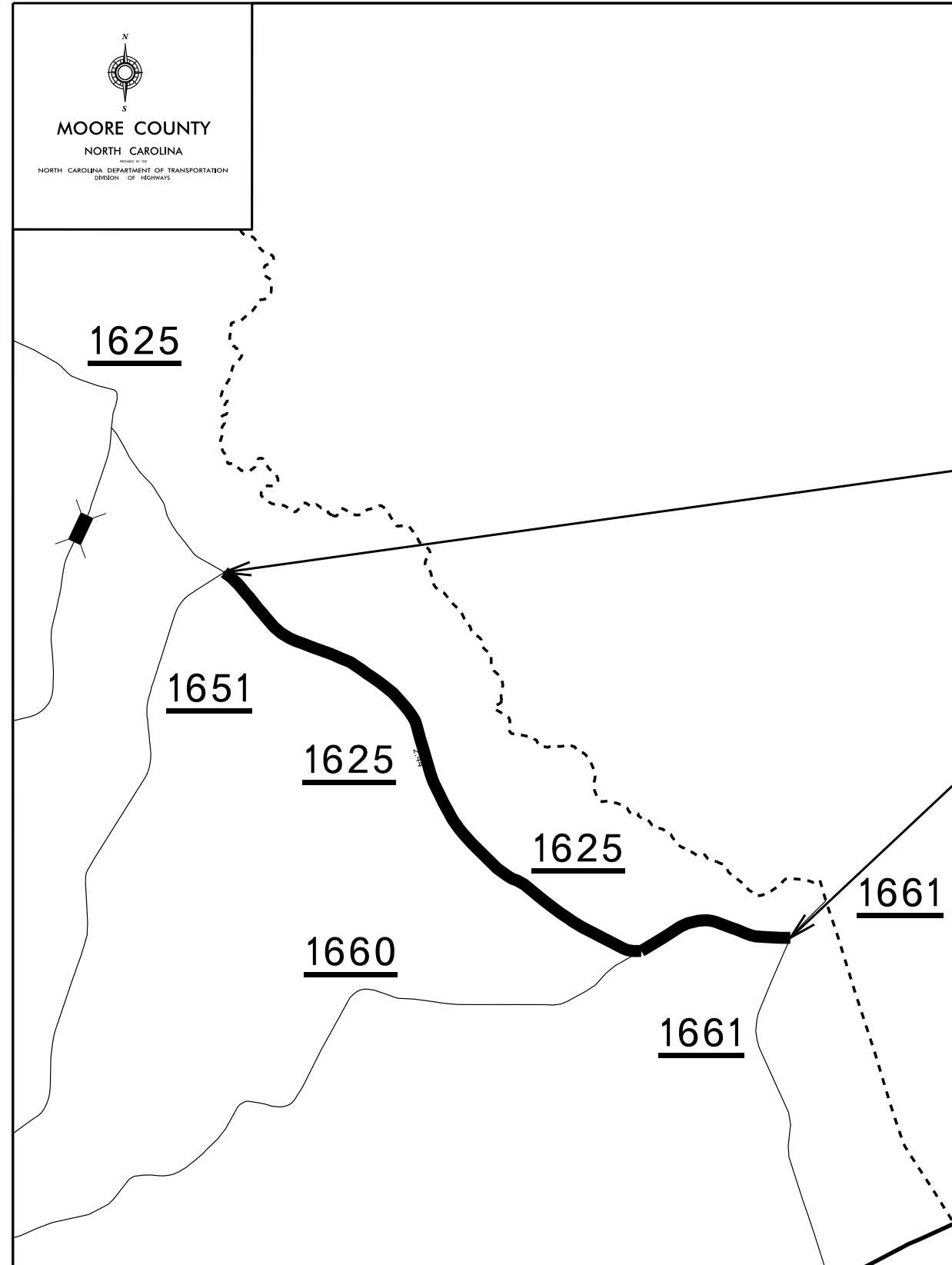

Map 12

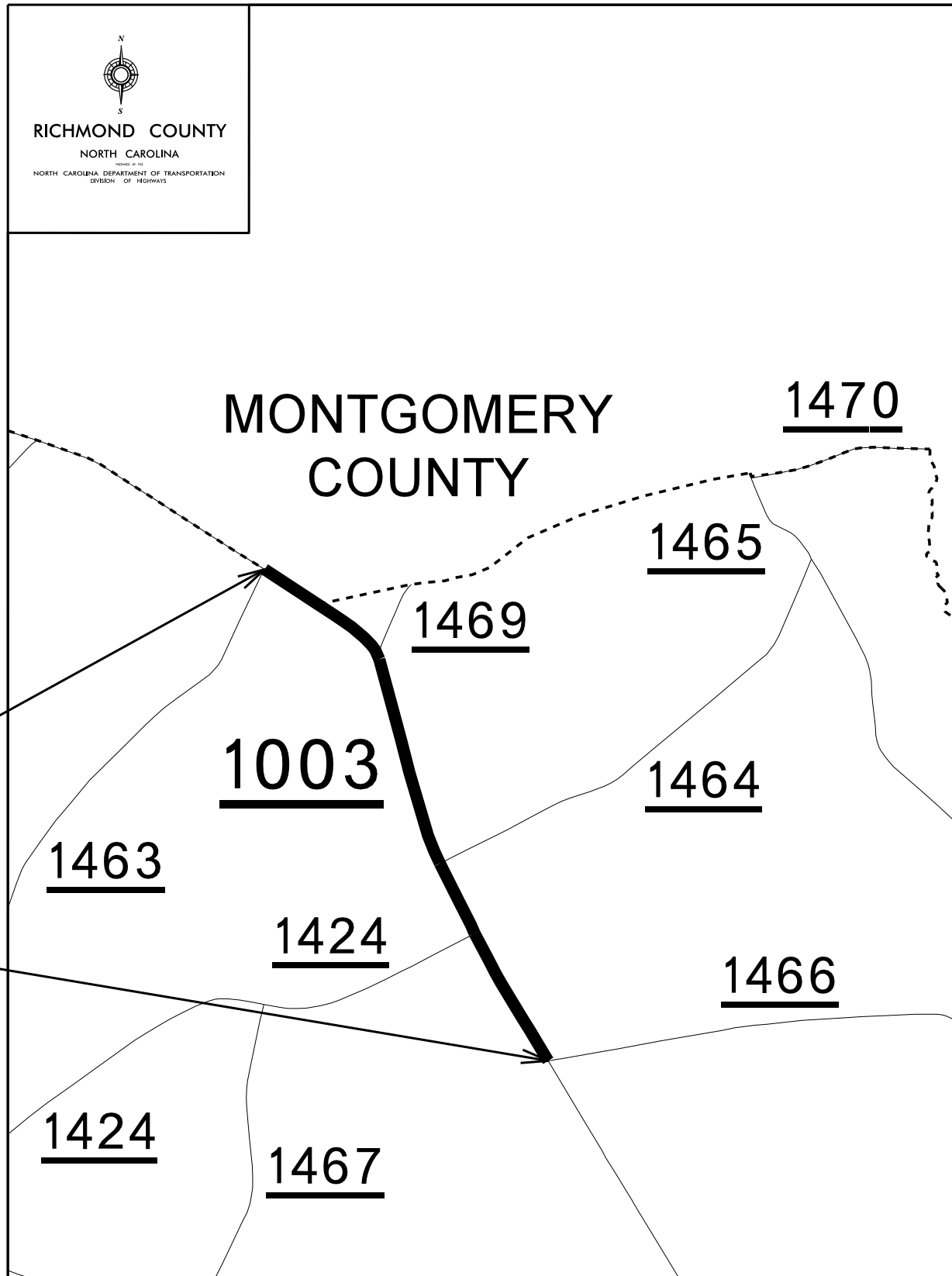

WBS ELEMENT	SHEET NO.
2024CPT.08.10.10772	15
2024CPT.08.10.20632	
2024CPT.08.10.20772	
8.206311 8.207711	

Map 13

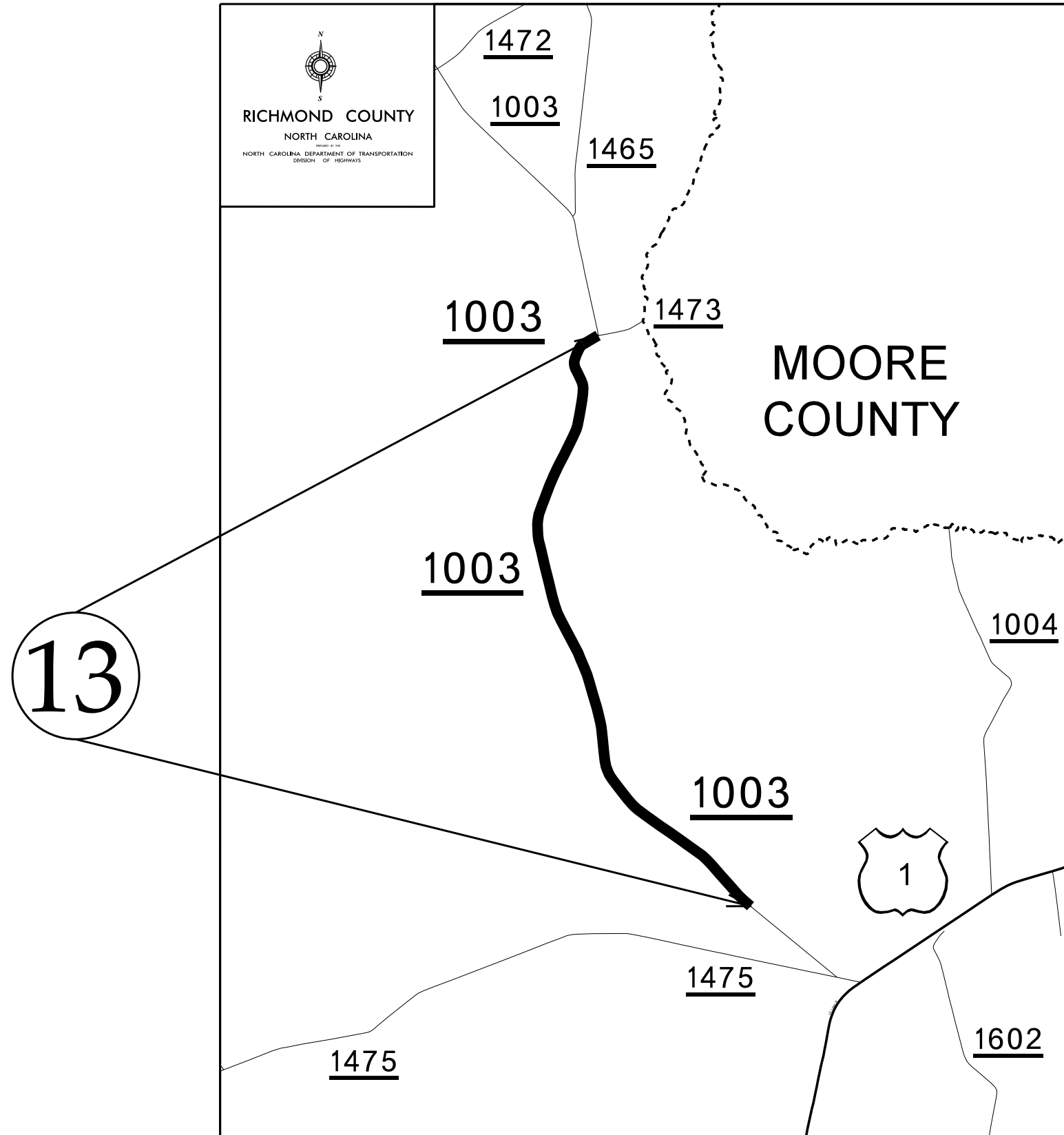

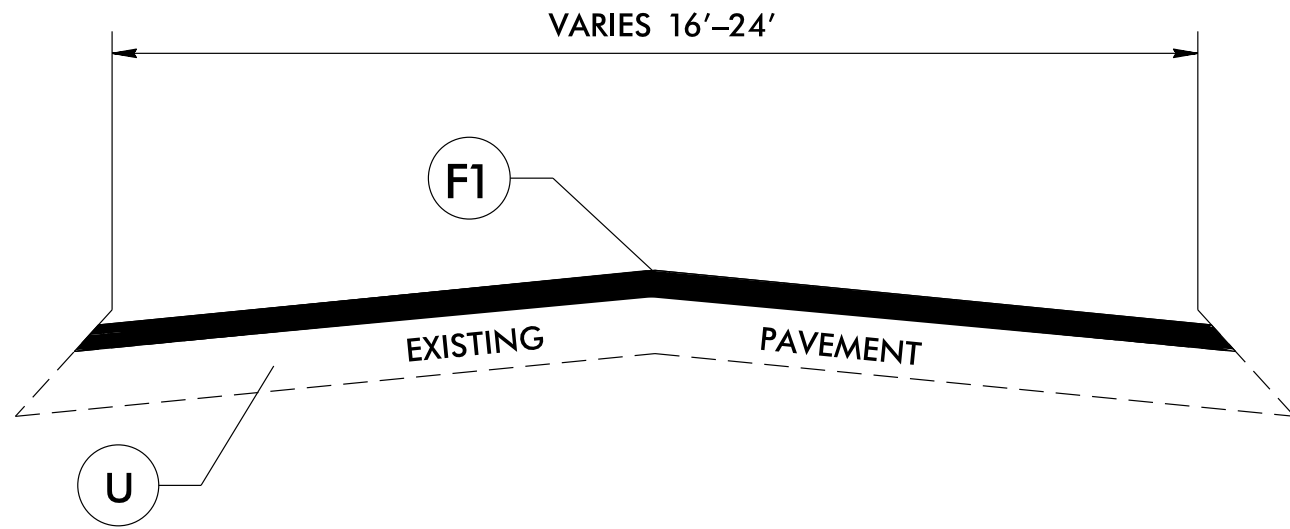

TYPICAL SECTION NO. 1

PAVEMENT SCHEDULE	
F1	PROP. ASPHALT SURFACE TREATMENT DOUBLE SEAL
F2	PROP. LATEX MODIFIED MICROSURFACING, TYPE II, AT A RATE OF 18 TO 22 LBS. PER SQ. YD.
U	EXISTING PAVEMENT

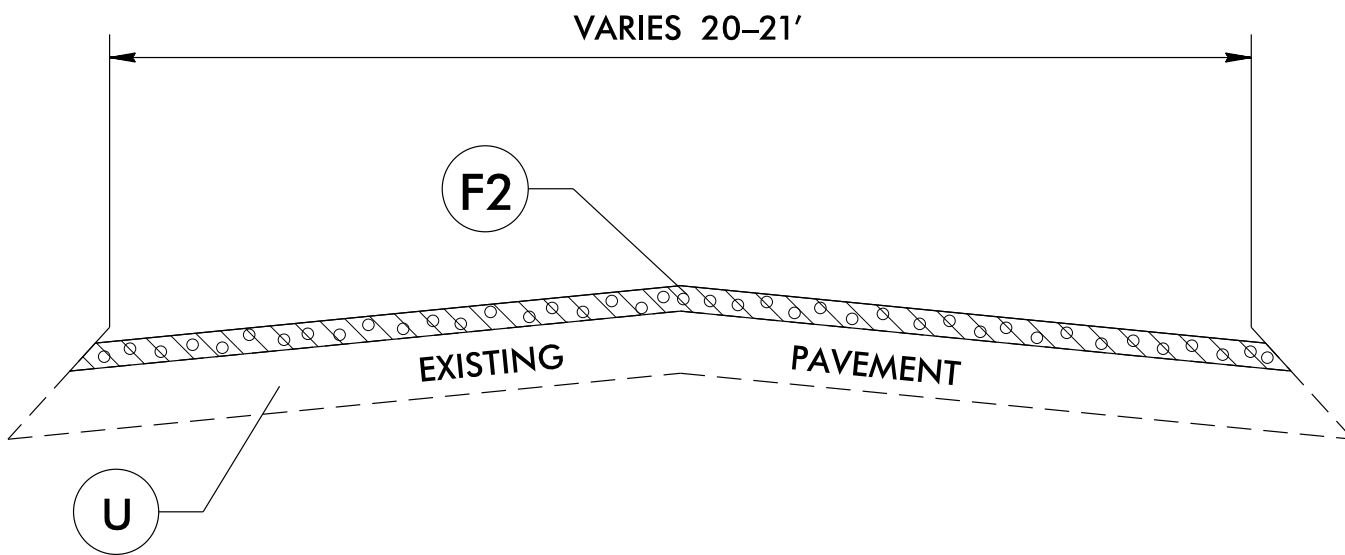

TYPICAL SECTION NO. 2

DETAILS OF PATCHING EXISTING PAVEMENT PRIOR TO RESURFACING

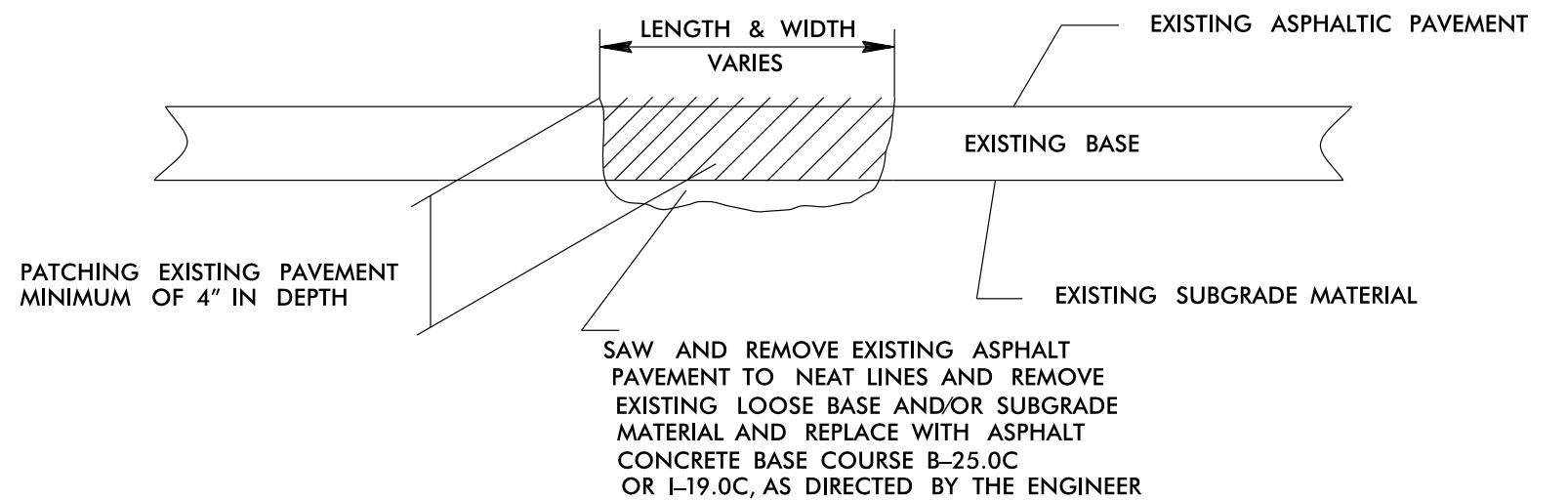

PROJECT NO.	SHEET NO.	TOTAL NO.
CPT.08.10.10772, 2024CPT.08.10.2024CPT.08.10.20772, ETC.	17	

SUMMARY OF QUANTITIES

PROJECT NO	COUNTY	MAP NO	ROUTE	DESCRIPTION	TYP NO	LANES	LANE TYPE	FINAL SURFACE TESTING REQUIRED	WARM MIX ASPHALT REQUIRED	LENGTH	WIDTH	BEGIN MP	END MP	102200000-E	157500000-E	170400000-E	180350000-E	183800000-E	183850000-N	189100000-E	214300000-E								
														SEALING EXISTING PAVEMENT CRACKS & JOINTS	ASPHALT BINDER FOR PLANT MIX	PATCHING EXISTING PAVEMENT	ASPHALT SURFACE TREATMENT, DOUBLE SEAL	EMULSION FOR ASPHALT SURFACE TREATMENT	VACUUM TRUCK	GENERIC PAVING ITEM - LATEX MODIFIED MICROSURFACING, TYPE II	BLOTTING SAND								
														MI	FT														
														LB	TONS	TONS	SY	GAL	WK	SY	TON								
2024CPT.08.10.10772	Richmond	1	NC 381 (HAMLET RD)	FROM SCOTLAND CO. LINE TO SR 1615 (OLD GIBSON RD)		2	2WU	NO	NO	2.91	24	0	2.91	10,440.00															
TOTAL FOR MAP NO. 1														2.91															
TOTAL FOR PROJ NO. 2024CPT.08.10.10772														2.91							10,440.00								
2024CPT.08.10.20632	Moore	2	SR-1661 / STANTON HILL RD	FROM SR 1814 (RED HILL RD) TO US 15-501	2	2	2WU	NO	NO	3.67	21	0	3.67						6.00	49,600	5								
TOTAL FOR MAP NO. 2														3.67									6.00	49,600	5				
2024CPT.08.10.20632	Moore	3	SR-2173 / LAKE BAY CHURCH RD	FROM SR 2023 (LAKEBAY RD) TO END OF STATE MAINTENANCE	1	2	2WU	NO	NO	0.16	16	0	0.16				1,502.00	826											
TOTAL FOR MAP NO. 3														0.16							1,502.00	826							
2024CPT.08.10.20632	Moore	4	SR-1305 / COMMUNITY RD	FROM NC 705 TO END OF STATE MAINTENANCE	1	2	2WU	NO	NO	0.67	20	0.02	0.69				7,862.00	4,324											
TOTAL FOR MAP NO. 4														0.67							7,862.00	4,324							
2024CPT.08.10.20632	Moore	5	SR-1250 / JODY RD	FROM SR 1252 (SHADY LANE) TO SR 1251 (BRINKLEY RD)	1	2	2WU	NO	NO	1.32	20	0.02	1.34				15,488.00	8,518											
TOTAL FOR MAP NO. 5														1.32							15,488.00	8,518							
2024CPT.08.10.20632	Moore	6	SR-1209 / MURDOCKSVILLE RD	FROM SR 1334 (WOOD RIVER RD) TO SR 1224 (DOUBS CHAPEL RD)	2	2	2WU	NO	NO	1.01	20	4.7	5.71							13,036									
TOTAL FOR MAP NO. 6														1.01										13,036					
2024CPT.08.10.20632	Moore	7	SR-1679 / ELMER-HOMER RD	FROM SR 1638 (PUTNAM CHURCH RD) TO END OF STATE MAINTENANCE	1	2	2WU	NO	NO	0.61	17	0	0.61				5,985.00	3,292											
TOTAL FOR MAP NO. 7														0.61							5,985.00	3,292							
2024CPT.08.10.20632	Moore	8	SR-1419 / BUSBEE RD	FROM NC 705 TO SR 1003 (NEEDHAM GROVE RD)	1	2	2WU	NO	NO	3.14	20	0	3.14				40,527.00	22,290											
TOTAL FOR MAP NO. 8														3.14							40,527.00	22,290							
2024CPT.08.10.20632	Moore	9	SR-2012 / PATS RD	FROM SR 2011 (BYRD RD) TO NC 690	1	2	2WU	NO	NO	1.53	19	0	1.53				17,658.00	9,711											
TOTAL FOR MAP NO. 9														1.53							17,658.00	9,711							
2024CPT.08.10.20632	Moore	10	SR-1900 / EUREKA CHURCH RD	FROM SR 1831 (FARM LIFE SCHOOL RD) TO SR 1841 (RAYS BRIDGE RD)	1	2	2WU	NO	NO	0.2	19	0	0.2				2,453.00	1,350											
TOTAL FOR MAP NO. 10														0.2							2,453.00	1,350							
2024CPT.08.10.20632	Moore	11	SR-1625 / UNDERWOOD RD	FROM SR 1661 (STANTON HILL RD) TO SR 1651 (OLD RIVER RD)	1	2	2WU	NO	NO	2.86	20	0	2.86				36,656.00	20,161											
TOTAL FOR MAP NO. 11														2.86							36,656.00	20,161							
TOTAL FOR PROJ NO. 2024CPT.08.10.20632														15.17							128,131.00	70,472	6.00	62,636	5				
2024CPT.08.10.20772	Richmond	12	SR-1003 / DERBY RD	FROM MONTGOMERY CO. LINE TO SR 1466 (SYCAMORE LN.)	1	2	2WU	NO	NO	1.51	20	0	1.51				17,725.00	9,749											
TOTAL FOR MAP NO. 12														1.51							17,725.00	9,749							
2024CPT.08.10.20772	Richmond	13	SR-1003 / DERBY RD	FROM SR 1473 (THUNDER RD.) TO C.J. 245 FT NORTHWEST OF JASPER DR	1	2	2WU	NO	NO	4.09	24	6.29	10.38				60,191.00	33,105	4.00		5								
TOTAL FOR MAP NO. 13														4.09							60,191.00	33,105	4.00		5				
TOTAL FOR PROJ NO. 2024CPT.08.10.20772														5.6							77,916.00	42,854	4.00		5				
8.206311	Moore	2	SR-1661 / STANTON HILL RD	FROM SR 1814 (RED HILL RD) TO US 15-501	2	2	2WU	NO	NO	3.67	21	0	3.67																
TOTAL FOR MAP NO. 2														3.67								3	60						
8.206311	Moore	4	SR-1305 / COMMUNITY RD	FROM NC 705 TO END OF STATE MAINTENANCE	1	2	2WU	NO	NO	0.67	20	0.02	0.69																
TOTAL FOR MAP NO. 4														0.67								3	70						
8.206311	Moore	5	SR-1250 / JODY RD	FROM SR 1252 (SHADY LANE) TO SR 1251 (BRINKLEY RD)	1	2	2WU	NO	NO	1.32	20	0.02	1.34																
TOTAL FOR MAP NO. 5														1.32								7	140						
8.206311	Moore	6	SR-1209 / MURDOCKSVILLE RD	FROM SR 1334 (WOOD RIVER RD) TO SR 1224 (DOUBS CHAPEL RD)	2	2	2WU	NO	NO	1.01	20	4.7	5.71																
TOTAL FOR MAP NO. 6														1.01								6	130						
8.206311	Moore	8	SR-1419 / BUSBEE RD	FROM NC 705 TO SR 1003 (NEEDHAM GROVE RD)	1	2	2WU	NO	NO	3.14	20	0	3.14																
TOTAL FOR MAP NO. 8														3.14								3	72						
8.206311	Moore	9	SR-2012 / PATS RD	FROM SR 2011 (BYRD RD) TO NC 690	1	2	2WU	NO	NO	1.53	19	0	1.53																
TOTAL FOR MAP NO. 9														1.53								3	60						
8.206311	Moore	10	SR-1900 / EUREKA CHURCH RD	FROM SR 1831 (FARM LIFE SCHOOL RD) TO SR 1841 (RAYS BRIDGE RD)	1	2	2WU	NO	NO	0.2	19	0	0.2																
TOTAL FOR MAP NO. 10														0.2								10	10						
8.206311	Moore	11	SR-1625 / UNDERWOOD RD	FROM SR 1661 (STANTON HILL RD) TO SR 1651 (OLD RIVER RD)	1	2	2WU	NO	NO	2.86	20	0	2.86																
TOTAL FOR MAP NO. 11														2.86								1	30						
TOTAL FOR PROJ NO. 8.206311														14.4								26	572						
8.207711	Richmond	12	SR-1003 / DERBY RD	FROM MONTGOMERY CO. LINE TO SR 1466 (SYCAMORE LN.)	1	2	2WU	NO	NO	1.51	20	0	1.51																
TOTAL FOR MAP NO. 12														1.51								7	152						
8.207711	Richmond	13	SR-1003 / DERBY RD	FROM SR 1473 (THUNDER RD.) TO C.J. 245 FT NORTHWEST OF JASPER DR	1	2	2WU	NO	NO	4.09	24	6.29	10.38																
TOTAL FOR MAP NO. 13														4.09								19	400						
TOTAL FOR PROJ NO. 8.207711														5.6								26	552						
GRAND TOTAL														43.68								10,440.00	52	1,124	206,047.00	113,326	10.00	62,636	10

PROJECT NO.	SHEET NO.	TOTAL NO.
PT.08.10.10772, 2024CPT.08.10.2024CPT.08.10.20772, ETC.	18	

THERMOPLASTIC AND PAINT QUANTITIES

PROJECT NO	COUNTY	MAP NO	ROUTE	DESCRIPTION	TYP NO	LANES	LANE TYPE	LENGTH	WIDTH	BEGIN MP	END MP	4413000000-E	4457000000-N	4815000000-E		4850000000-E		
												WORK ZONE ADVANCE/GENERAL WARNING SIGNING	TEMPORARY TRAFFIC CONTROL	6" WHITE PAINT	6" YELLOW PAINT	4" LINE REMOVAL		
												SF	LS	LF	LF	LF		
2024CPT.08.10.10772	Richmond	1	NC 381 (HAMLET RD)	FROM SCOTLAND CO. LINE TO SR 1615 (OLD GIBSON RD)		2	2WU	2.91	24	0	2.91							
TOTAL FOR MAP NO. 1												2.91						
TOTAL FOR PROJ NO. 2024CPT.08.10.10772												2.91						
2024CPT.08.10.20632	Moore	2	SR-1661 / STANTON HILL RD	FROM SR 1814 (RED HILL RD) TO US 15-501	2	2	2WU	3.67	21	0	3.67	410		78,763	66,022	72,393		
TOTAL FOR MAP NO. 2												3.67			410	78,763	66,022	72,393
2024CPT.08.10.20632	Moore	3	SR-2173 / LAKE BAY CHURCH RD	FROM SR 2023 (LAKEBAY RD) TO END OF STATE MAINTENANCE	1	2	2WU	0.16	16	0	0.16	18		3,443	3,380			
TOTAL FOR MAP NO. 3												0.16			18	3,443	3,380	
2024CPT.08.10.20632	Moore	4	SR-1305 / COMMUNITY RD	FROM NC 705 TO END OF STATE MAINTENANCE	1	2	2WU	0.67	20	0.02	0.69	76		14,418	14,152			
TOTAL FOR MAP NO. 4												0.67			76	14,418	14,152	
2024CPT.08.10.20632	Moore	5	SR-1250 / JODY RD	FROM SR 1252 (SHADY LANE) TO SR 1251 (BRINKLEY RD)	1	2	2WU	1.32	20	0.02	1.34	148		28,406	27,880			
TOTAL FOR MAP NO. 5												1.32			148	28,406	27,880	
2024CPT.08.10.20632	Moore	6	SR-1209 / MURDOCKSVILLE RD	FROM SR 1334 (WOOD RIVER RD) TO SR 1224 (DOUBS CHAPEL RD)	2	2	2WU	1.01	20	4.7	5.71	114		21,735	21,332	21,534		
TOTAL FOR MAP NO. 6												1.01			114	21,735	21,332	21,534
2024CPT.08.10.20632	Moore	7	SR-1679 / ELMER-HOMER RD	FROM SR 1638 (PUTNAM CHURCH RD) TO END OF STATE MAINTENANCE	1	2	2WU	0.61	17	0	0.61	68		12,912	12,672			
TOTAL FOR MAP NO. 7												0.61			68	12,912	12,672	
2024CPT.08.10.20632	Moore	8	SR-1419 / BUSBEE RD	FROM NC 705 TO SR 1003 (NEEDHAM GROVE RD)	1	2	2WU	3.14	20	0	3.14	352		67,573	66,316			
TOTAL FOR MAP NO. 8												3.14			352	67,573	66,316	
2024CPT.08.10.20632	Moore	9	SR-2012 / PATS RD	FROM SR 2011 (BYRD RD) TO NC 690	1	2	2WU	1.53	19	0	1.53	171		32,710	32,104			
TOTAL FOR MAP NO. 9												1.53			171	32,710	32,104	
2024CPT.08.10.20632	Moore	10	SR-1900 / EUREKA CHURCH RD	FROM SR 1831 (FARM LIFE SCHOOL RD) TO SR 1841 (RAYS BRIDGE RD)	1	2	2WU	0.2	19	0	0.2	23		4,304	4,301			
TOTAL FOR MAP NO. 10												0.2			23	4,304	4,301	
2024CPT.08.10.20632	Moore	11	SR-1625 / UNDERWOOD RD	FROM SR 1661 (STANTON HILL RD) TO SR 1651 (OLD RIVER RD)	1	2	2WU	2.86	20	0	2.86	319		61,117	61,112			
TOTAL FOR MAP NO. 11												2.86			319	61,117	61,112	
TOTAL FOR PROJ NO. 2024CPT.08.10.20632												15.17			1,699	325,381	309,271	93,927
																634,652		
2024CPT.08.10.20772	Richmond	12	SR-1003 / DERBY RD	FROM MONTGOMERY CO. LINE TO SR 1466 (SYCAMORE LN.)	1	2	2WU	1.51	20	0	1.51	169		54,768	38,152			
TOTAL FOR MAP NO. 12												1.51			169	54,768	38,152	
2024CPT.08.10.20772	Richmond	13	SR-1003 / DERBY RD	FROM SR 1473 (THUNDER RD.) TO C.J. 245 FT NORTHWEST OF JASPER DR	1	2	2WU	4.09	24	6.29	10.38	458		86,270	60,596			
TOTAL FOR MAP NO. 13												4.09			458	86,270	60,596	
TOTAL FOR PROJ NO. 2024CPT.08.10.20772												5.6			627	141,038	98,748	
																239,786		
8.206311	Moore	2	SR-1661 / STANTON HILL RD	FROM SR 1814 (RED HILL RD) TO US 15-501	2	2	2WU	3.67	21	0	3.67							
TOTAL FOR MAP NO. 2												3.67						
8.206311	Moore	4	SR-1305 / COMMUNITY RD	FROM NC 705 TO END OF STATE MAINTENANCE	1	2	2WU	0.67	20	0.02	0.69							
TOTAL FOR MAP NO. 4												0.67						
8.206311	Moore	5	SR-1250 / JODY RD	FROM SR 1252 (SHADY LANE) TO SR 1251 (BRINKLEY RD)	1	2	2WU	1.32	20	0.02	1.34							
TOTAL FOR MAP NO. 5												1.32						
8.206311	Moore	6	SR-1209 / MURDOCKSVILLE RD	FROM SR 1334 (WOOD RIVER RD) TO SR 1224 (DOUBS CHAPEL RD)	2	2	2WU	1.01	20	4.7	5.71							
TOTAL FOR MAP NO. 6												1.01						
8.206311	Moore	8	SR-1419 / BUSBEE RD	FROM NC 705 TO SR 1003 (NEEDHAM GROVE RD)	1	2	2WU	3.14	20	0	3.14							
TOTAL FOR MAP NO. 8												3.14						
8.206311	Moore	9	SR-2012 / PATS RD	FROM SR 2011 (BYRD RD) TO NC 690	1	2	2WU	1.53	19	0	1.53							
TOTAL FOR MAP NO. 9												1.53						
8.206311	Moore	10	SR-1900 / EUREKA CHURCH RD	FROM SR 1831 (FARM LIFE SCHOOL RD) TO SR 1841 (RAYS BRIDGE RD)	1	2	2WU	0.2	19	0	0.2							
TOTAL FOR MAP NO. 10												0.2						
8.206311	Moore	11	SR-1625 / UNDERWOOD RD	FROM SR 1661 (STANTON HILL RD) TO SR 1651 (OLD RIVER RD)	1	2	2WU	2.86	20	0	2.86							
TOTAL FOR MAP NO. 11												2.86						
TOTAL FOR PROJ NO. 8.206311												14.4						
8.207711	Richmond	12	SR-1003 / DERBY RD	FROM MONTGOMERY CO. LINE TO SR 1466 (SYCAMORE LN.)	1	2	2WU	1.51	20	0	1.51							
TOTAL FOR MAP NO. 12												1.51						
8.207711	Richmond	13	SR-1003 / DERBY RD	FROM SR 1473 (THUNDER RD.) TO C.J. 245 FT NORTHWEST OF JASPER DR	1	2	2WU	4.09	24	6.29	10.38							

SIGNING FOR ASPHALT SURFACE TREATMENT

LEGEND

- ⏏ PORTABLE SIGN
- └ STATIONARY SIGN
- ← DIRECTION OF TRAFFIC FLOW

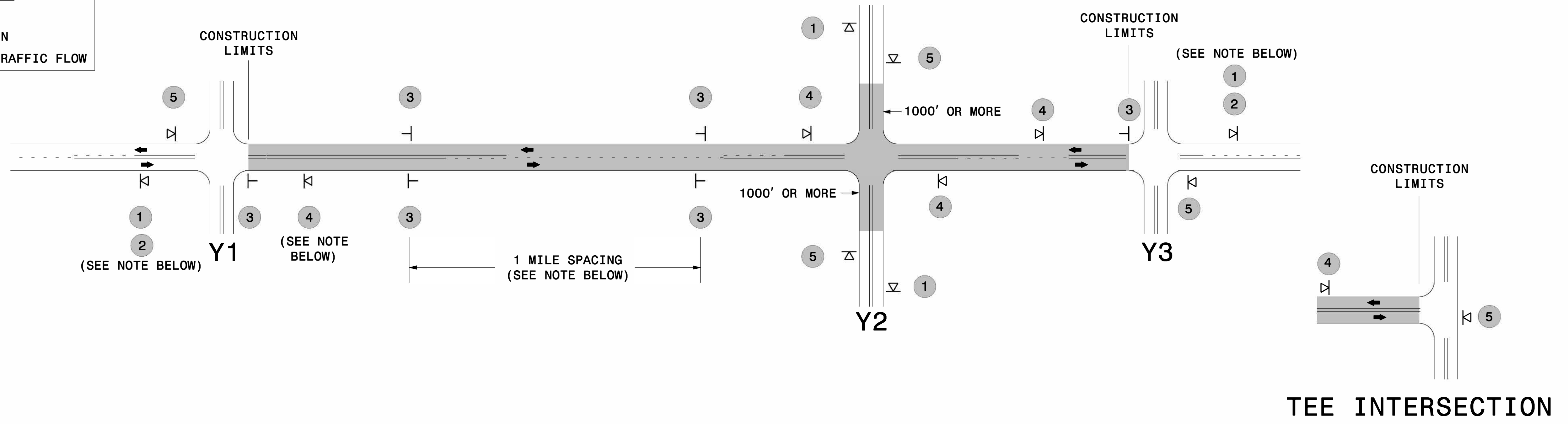

MAINLINE (-L-) SIGNING

-Y- LINE SIGNING

SIGNING NOTES AND PLACEMENT PER DIRECTION	1	 	<ul style="list-style-type: none"> - PLACE 1000' PRIOR TO BEGINNING OF CONSTRUCTION LIMITS. ONLY USED ON -Y- LINES IF RESURFACING LIMITS EXTEND 1000' ALONG -Y- LINE. - SIGN #2 ONLY USED WHEN RESURFACING LIMITS ARE 2 OR MORE MILES IN LENGTH. ROUND UP TO THE NEAREST WHOLE NUMBER. DO NOT USE FRACTIONAL OR DECIMAL NUMBERS. 	<p>STATIONARY SIGNING NOT REQUIRED FOR THE FOLLOWING -Y- LINE CONDITIONS:</p> <ol style="list-style-type: none"> 1) LESS THAN 1000' OF RESURFACING ALONG -Y- LINE 2) SUBDIVISION ROADS 3) DEAD END ROADS <p>WHEN PAVING/CONSTRUCTION ACTIVITIES PROCEED ACROSS AN UNSIGNED -Y- LINE, PORTABLE ADVANCE WARNING SIGNS SHALL BE USED ALONG THE -Y- LINE AS SHOWN BELOW. REMOVE UPON COMPLETION OF WORK.</p> <div style="display: flex; justify-content: space-around; align-items: center;"> <div style="text-align: center;"> <small>W20-1 48" X 48"</small> PLACED 500' IN ADVANCE OF FLAGGER. </div> <div style="text-align: center;"> <small>W20-7 A 48" X 48"</small> PLACED 250' IN ADVANCE OF FLAGGER. </div> </div>
	3	 	<ul style="list-style-type: none"> - ALTERNATE THE FOLLOWING TWO SIGNS: - STARTING WITH "LOOSE GRAVEL" (W8-7) FOLLOWED BY "UNMARKED PAVEMENT". - PLACE INITIALLY AT THE CONSTRUCTION LIMITS AND SPACED 1 MILE APART THEREAFTER. - AT TEE INTERSECTIONS INSTALL INITIALLY 0.5 MILE FROM INTERSECTION AND SPACE 1 MILE APART THEREAFTER. 	
	4		<ul style="list-style-type: none"> - THESE ARE FOR -Y- LINES THAT ARE "THROUGH" ROADWAYS. DEAD END AND SUBDIVISION ROADS ARE NOT "THROUGH" ROADWAYS. - INSTALL 500' +/- FROM EACH -Y- LINE APPROACH AS SHOWN ABOVE. - FOR MULTIPLE -Y- LINES THAT ARE SEPARATED BY 0.25 MILES OR LESS, TREAT AS A SINGLE UNIT AND INSTALL WITHIN 500' OF EACH APPROACH. - A MAXIMUM OF 2 SIGN SETS PER MILE. DO NOT INSTALL WHEN -Y- LINES ARE WITHIN 0.5 MILES FROM "END ROAD WORK" SIGN. 	
	5		<ul style="list-style-type: none"> - PLACE 500' FOLLOWING THE END OF CONSTRUCTION LIMITS OR AS SHOWN WHEN WORK ENDS AT A 3-WAY TEE INTERSECTION. 	
	<p>THE ABOVE SIGNS ARE ALL THAT ARE REQUIRED FOR A CONTRACTOR TO BEGIN A RESURFACING CONTRACT. ANY ADDITIONAL SIGNS REQUESTED BY NCDOT DIVISIONS SHALL BE INSTALLED WITHIN 7 BUSINESS DAYS OF THE START OF CONTRACT WORK.</p>			

MAPS LESS THAN 2 MILES

FOR AST RESURFACING MAPS WITH CONSTRUCTION LIMITS LESS THAN 2 MILES IN LENGTH, USE A STATIONARY "LOOSE GRAVEL" SIGN AT THE BEGINNING CONSTRUCTION LIMIT FOLLOWED BY AN "UNMARKED PAVEMENT" SIGN MIDWAY THROUGH AND AN "END ROAD WORK" SIGN AT THE END CONSTRUCTION LIMIT.



ADVANCE WARNING SIGNS FOR 2-LANE ROADWAY ASPHALT SURFACE TREATMENT

5/12/2017 S:\TMD\WZTC\Resurfacing\2L2W & AST Resurfacing Details\Resurfacing_AdvWarn_2Ln - AST.dgn User:hdais